

# SHIMANO

## SHIMANO EUROPA

Industrieweg 24 NL-8071 CT Nunspeet, Holland  
Phone 31-3412-72222

## SHIMANO AMERICAN CORPORATION

One Shimano Drive, P.O. Box 19615, Irvine,  
California U.S.A. 92713-9615 Phone 714-951-5003

## Small parts list for after market.

- You may photocopy this sheet and use it as an order form.
- Sie können dieses Blatt kopieren und als Bestellformular verwenden.
- Vous pouvez photocopier cette feuille et l'utiliser comme bon de commande.
- Dit blad kan gecopieerd en als bestelformulier gebruikt worden.
- Potete fotocopiare questo foglio e usarlo come modulo di commissione.

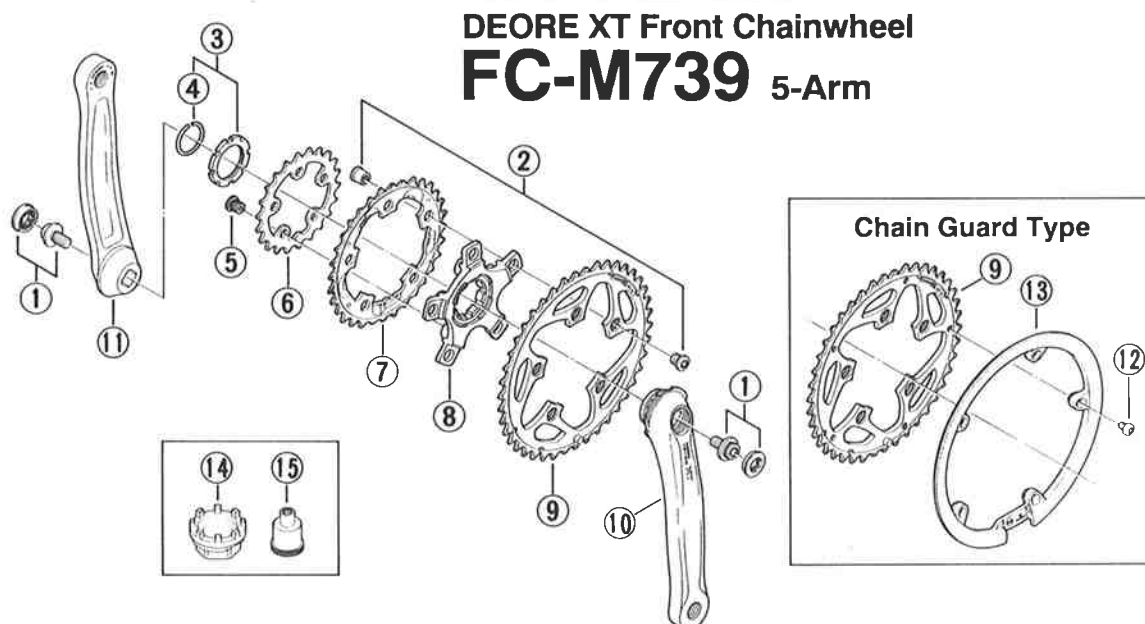

- Bolt circle diameter: 94 mm...(For outer gear and middle gear), 58 mm...(For inner gear)

Q'TY	ITEM NO.	SHIMANO CODE NO.	DESCRIPTION
	1	16M 9010	Crank Arm Fixing Bolt & Cap
	2	16M 9801	Double Gear Fixing Bolt (M8 × 8.5) & Nut (5 sets)
	3	1BD 9802	Lock Nut & Stop Ring
	4	1BD 1600	Lock Nut Stop Ring
	5	1DB 9802	Inner Gear Fixing Bolt (M8 × 8.5 / 5 pcs.)
	6	16M 2200	Chainring 22T (Silver)
	7	16M 9320	Chainring 32T (Silver)
	8	17N 1700	5-Arm Adapter
	9	16M 9420	Chainring 42T (Black)
		16M 9421	Chainring 42T (Black) for Chain Guard
		16M 9440	Chainring 44T (Black)
		16M 9441	Chainring 44T (Black) for Chain Guard
	10	17N 0100	Right Hand Crank Arm 165 mm
		17N 0200	Right Hand Crank Arm 167.5 mm
		17N 0300	Right Hand Crank Arm 170 mm
		17N 0400	Right Hand Crank Arm 172.5 mm
		17N 0500	Right Hand Crank Arm 175 mm
		17N 0600	Right Hand Crank Arm 177.5 mm
		17N 0700	Right Hand Crank Arm 180 mm
		17N 0110	Left Hand Crank Arm 165 mm
	11	17N 0210	Left Hand Crank Arm 167.5 mm
		17N 0310	Left Hand Crank Arm 170 mm
		17N 0410	Left Hand Crank Arm 172.5 mm
		17N 0510	Left Hand Crank Arm 175 mm
		17N 0610	Left Hand Crank Arm 177.5 mm
	12	17N 0710	Left Hand Crank Arm 180 mm
		16K 9803	Chain Guard Fixing Bolt (5 pcs.)
	13	1BD 1410	Chain Guard for 42T
		16M 1000-1	Chain Guard for 44T
	14	130 0907-2	TL-UN96 Special Tool A
	15	130 0906-8	TL-UN75 Special Tool